

Series SKUDO Safes

Stainless steel magnetic protector for double bit key safes



Characteristics

SKUDO Safes is a security upgrade designed specifically for safes with older locks.

Ideal for improving the protection of old double-bit locks, there is no need to replace the safe: thanks to its easy installation, **SKUDO Safes** can be applied in just a few minutes and increases the resistance of the lock, making it resistant to drills, lock picks and other burglary tools.

MAXIMUM RESISTANCE, Stainless steel body with anti-drill front plate.

EASY INSTALLATION, It can be mounted quickly, even on old safes, drilling is made easy using an adhesive template

UNIVERSAL, Compatible with all double-bit locks installed on our Safes.

MODERN AND RESISTANT DESIGN, Minimal, solid, discreet and designed to last over time.

- Material: stainless-steel
- Thickness: 10,2 mm
- Finish: natural stainless-steel
- Weight: 0,95 kg

Equipment:

- Punching and drilling template
- 2 magnetic keys
- 5 high strenght M5 x 14 mm screw, conical head

On request it's possible to produce a magnetic key in KA with DISEC Series 3G and MR500 Magnetic Protector

Codes and product information

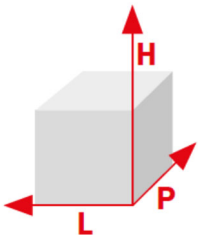

Code	External dimensions mm LPH	Thickness mm	Package	Sales Unit	Weight Kg	Volume Lt
100500PRO	85*135*48	10,2	Box	1	0,95	6,30

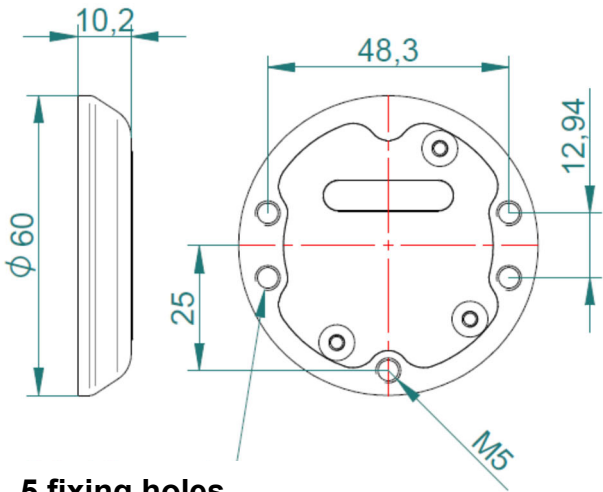
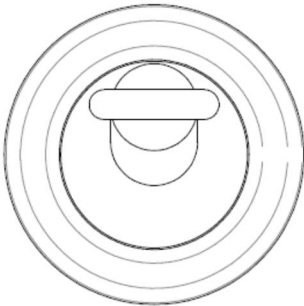

5 fixing holes